



Service Information

ACCESS LAVE-LINGE

WAK 7550-NL

8583 421 12004

Last Modification: 09/25/08

LISTE DE PIECES	2
DONNEES TECHNIQUES	5
VUE ECLATEE	9
SCHEMA DE CABLAGE	11
SCHEMA DE CIRCUITS	12
CHARTE PROGRAMME	13
LEGENDE DES TEXTES	20

This document is only intended for qualified technicians who are aware of the respective safety regulations.
Subject to modifications

LISTE DE PIECES

Pos No	12NC	Description
001 0	4812 440 10816	CARROSSERIE (GW)
002 0	4812 440 10812	TRAPPE BOUCHON POMPE VID.
003 0	4812 464 48112	TRaverse SUP. ARRIERE
011 0	4812 500 18068	PIED REGLABLE
021 0	4812 440 10814	FACADE (GW)
024 0	4812 310 18653	PANNEAU ARRIERE
025 0	4812 440 10467	SUPPORT COMPOSANTS ELECTR.
030 0	4812 440 10813	TABLE TOP (GW)
040 0	4812 417 18787	CHARNIERE HUBLLOT
050 0	4812 440 89046	PLINTHE (GW)
061 1	4812 466 88463	CONTREPOIDS AVANT
081 0	4812 466 48057	AMORTISSEUR DE CUVE
081 1	4812 502 18424	VIS AMORTISSEUR
084 0	4812 466 58001	SILENTBLOC RESSORT SUP.
084 1	4812 404 68021	SUPPORT RESSORT
086 0	4812 401 18409	SUPPORT AMORTISSEUR INF.
086 2	4812 401 18412	BLOCAGE AMORTISSEUR
110 0	4812 498 18261	POIGNEE PORTE GW
130 0	4812 417 28047	PLAQUE INSERT HAUT HUBLLOT
130 1	4812 417 28048	PLAQUE INSERT BAS HUBLLOT
131 0	4812 417 28046	CROCHET DE PORTE
131 1	4812 417 28045	AXE DE POIGNEE
131 2	4812 492 58022	RESSORT POIGNEE PORTE
135 1	4812 498 18262	TOUCHE SECURITE ENFANT
135 2	4812 492 58023	RESSORT SECURITE ENFANT
135 3	4812 290 68153	SUPPORT REGLABLE
140 0	4812 450 68218	HUBLLOT EN VERRE
143 0	4812 440 10815	CADRE VITRE (GW)
144 0	4812 440 10785	CADRE INTERIEUR HUBLLOT GW
144 3	4812 502 48015	VIS 4x16-TORX
191 0	4812 466 68557	JOINT DE HUBLLOT
191 1	4812 492 18015	COLLIER AR. JOINT HUBLLOT
191 2	4812 492 98011	COLLIER AV. JOINT HUBLLOT
200 0	4812 418 18181	CUVE INOX
201 0	4812 464 48002	FLASQUE DE CUVE
210 0	4812 520 18071	MASSE + PALIERS TAMBOUR
210 1	4812 452 18994	VIS M8x20 A2F
220 0	4812 418 18178	TAMBOUR INOX 48l
271 0	4812 358 18157	COURROIE BK 1254 J5
272 0	4812 528 58004	POULIE TAMBOUR
272 1	4812 532 28006	CONE POULIE
272 2	4812 532 18024	RONDELLE MONTAGE POULIE
272 3	4819 502 18417	VIS DE POULIE 8x25
292 0	4812 530 58003	JOINT FLASQUE DE CUVE
301 0	4812 452 12303	BANDEAU GW
303 0	4812 498 18278	POIGNEE TIROIR (GW)
321 0	4812 452 12635	PLAQUE DECOR WAK 7550
331 0	4812 413 18292	BOUTON PROGRAM. (GW)

Pos No	12NC	Description
332 0	4812 410 29092	POUSSOIR OPTIONS (GW)
332 1	4812 410 29088	POUSSOIR TEMP. +
332 2	4812 410 29089	POUSSOIR TEMP. -
333 0	4812 410 29091	POUSSOIR DEPART/PAUSE GW
400 0	4812 361 58093	MOTEUR MCA52/148-1200
400 1	4812 502 18361	VIS M8x30
409 0	4812 362 48004	CHARBON MOTEUR CESET
421 0	4812 121 18142	FILTRE ANTIPARASITES 1,00 µF
430 0	4812 310 18458	POMPE DE VIDANGE
451 0	4812 259 28669	THERMOPLONGEUR + CTN/2050 W
480 0	4812 321 78111	CABLE
490 0	4819 321 18136	CORDON SECTEUR 2 m
491 0	4812 321 28367	BORNIER D' ALIMENTATION
491 1	4812 502 38152	VIS 4,8x19
521 0	4812 214 78731	PLATINE CONTROL 1200 VBL BK
571 0	4812 271 28375	ELECTROVANNE EAU
582 0	4812 271 28394	PRESSOSTAT 2 NIVEAUX
620 0	4812 276 28391	MODULE BK1 C, OMEGA
630 0	4812 280 58019	SECURITE DE PORTE
701 0	4812 530 29127	TUYAU D'ARRIVEE D'EAU 1,5 m
701 1	4819 466 69704	JOINT ET FILTRE EAU
702 0	4819 530 29019	DURIT ARRIVEE D'EAU
703 0	4812 530 48162	TUYAU RINCAGE HUBLLOT
707 0	4812 526 48031	INJECTEUR DISTRIBUTION EAU
707 1	4812 526 48028	INJECTEUR DURIT ARRIVEE D'EAU
707 2	4812 530 48161	DIFFUSEUR EAU RINCAGE HUBLLOT
707 3	4812 530 78011	RONDELLE JOINT HUBLLOT
708 1	4812 530 48355	DURITE COUDEE
711 0	4812 418 68166	BOITE A PRODUIT 3 BACS
712 0	4812 418 88051	TIROIR PRODUITS
713 0	4812 418 89009	PORTILLON MOBILE DE TIROIR GW
717 0	4812 323 18006	MODULE MOTEUR LEVIER INJECTEUR
717 1	4812 321 38015	LEVIER REGLAGE DISTRIBUTION
717 2	4812 321 38014	LEVIER JONCT. ARR.
717 3	4812 321 38016	CLIQUET JONCT. DISTRIBUTION
717 5	4812 310 18459	CAME DISTRIBUTION
718 0	4812 526 48157	SIPHON GW
718 1	4812 418 88018	ACCESSOIRE TRAPPE PV / LL
750 0	4812 530 48139	CHAMBRE CLAPET LESSIVE
753 1	4812 418 68125	CHAMBRE DE COMPRESSION
754 0	4812 530 28838	DURIT CUVE POMPE + JOINT
754 4	4812 401 18054	COLLIER DURIT CUVE POMPE
760 0	4812 480 58105	FILTRE POMPE VIDANGE
781 0	4819 530 28959	TUYAU VIDANGE
782 0	4812 530 28816	TUYAU PRESSOSTAT
783 3	4812 530 18001	CONE FIXATION DURIT
783 4	4812 530 28818	TUYAU INTERNE VIDANGE
787 0	4812 530 28819	DURIT MISE A L'AIR LIBRE
787 2	4819 401 18868	COLLIER DURIT MISE AIR LIBRE
794 2	4812 530 58005	JOINT TORIQUE DURIT
794 5	4812 530 58015	JOINT CHAMBRE COMPRESSION

Pos No	12NC	Description
900 0	4812 255 18204	SUPPORT TUYAUX
900 1	4812 290 88043	PASSE - FILS COTE D.
900 2	4812 401 18501	FIXATION TUYAU 19,2 mm
900 3	4812 290 88048	SUPPORT FILS COTE CARROSS.
900 4	4812 401 18414	COLLIER DURIT BAC PROD./CUVE
900 8	4819 401 18823	AGRAFE TUYAU VIDANGE
900 9	4812 401 48569	AGRAFE
910 0	4812 502 48344	VIS TABLE TOP
910 3	4812 502 18409	VIS MODULE MOTEUR
910 4	4812 930 08022	VIS 4.2x13-F-H
911 7	4812 903 08196	VIS CHARNIERE M 5X14-Z
921 0	4819 903 00796	SERRE CLIP 47x1,75 D4
930 0	4812 492 38357	RESSORT SUP. DE CUVE
930 5	4812 492 38359	RESSORT D' INJECTEUR
941 0	4812 520 28071	ROULEMENT 6305
941 1	4812 520 28072	ROULEMENT 6303
953 0	4812 530 68001	JOINT V RING D'ETANCHEITE
961 0	4812 395 98005	BRIDAGE BLOC LAVEUR
962 0	4812 466 38011	CACHE THERMOPLONGEUR
965 0	4812 466 68545	CACHE BRIDAGE
993 0	4819 530 29028	CROSSE TUYAU VIDANGE
993 3	4812 395 58004	CLEF REGLAGE PIEDS / BRIDAGE

DONNEES TECHNIQUES

DIMENSIONS + POIDS

DIMENSIONS APPAREIL

HAUTEUR	85 cm
LARGEUR	59.5 cm
PROFONDEUR	60 cm

POIDS

AVEC LA PROTECTION DE BRUIT	74 kg
SANS PROTECTION DE BRUIT	73 kg

ALIMENTATION

TENSION	230 V
FREQUENCE	50 Hz
FUSIBLE	10 A
PUISS. CONSOMMEE	2.3 kW

TAMBOUR

VOLUMES	48 l
ROTATION LAVAGE	40/ 54 rpm
ROTATION PRE-ESSORAGE	90 rpm
ROTATION ESSORAGE MAX.	1000 rpm

CHARGE DE LINGE SEC

COTON COLORE	5 kg
COTON RAPIDE	3 kg
DELICAT	1.5 kg
SYNTHETIQUE	2.5 kg
SYNTHETIQUE RAPID	1.5 kg
LAINE	1 kg

PRESSOSTAT

for washing-machine

NIVEAU 1

NIVEAU TRAVAIL	50 ± 5 mmWc
ANNULATION PROGRAMMES	25 ± 5 mmWc

DEBORDEMENT

NIVEAU TRAVAIL	280 ± 20 mmWc
----------------------	---------------

TAMBOUR DE NIVEAU D'EAU

NIVEAU 1

NIVEAU TRAVAIL	31 mm - 42 mm
----------------------	---------------

DEBORDEMENT

NIVEAU TRAVAIL	267 mm - 306 mm
----------------------	-----------------

INTENSITE NOM.

CONTACT

11 - 12 10mA

11 - 14 10mA

11 - 16 10mA

CONTACT SYSTEME

11- 12 - 14 jump contacts

11 - 16 slow action contacts

VERROUILLAGE DE PORTE

TEMPS DE FERMETURE max.6"(20°C)

TEMPS D'OUVERTURE 60"- 90"

TENSION NOMINALE 230 V

INTENSITE NOM.

CONTACT 4 - 5 1 mA 11 - 14 10 mA

ELEMENT CHAUFFANT

TYPE DE CHAUFFAGE Tubular heating element

TENSION NOMINALE 230 V

PUISSANCE DE RACCORDEMENT 2050 W

CONDUCTEUR DE LA CHALEUR R25

MIN. 22 Ω

MAX. 28 Ω

RESISTANCE CTN

0 °C 35.9 kΩ

30 °C 9.8 kΩ

40 °C 6.6 kΩ

50 °C 4.6 kΩ

60 °C 3.2 kΩ

70 °C 2.3 kΩ

95 °C 1.1 kΩ

ELECTRONIQUE

DE BASE 4619 710 74091

PROGRAMMEE 4619 710 75391

TENSION NOMINALE 230 V

FREQUENCE 50 Hz

DISTRIBUTEUR DETERGENT 3 Chamber

PROGRAMMES 11

SUFFISANCE FROIDE yes

VITESSE 1000 rpm

TEMPERATURE DE FONCTIONNEMENT up to 70 °C

TEMPERATURE DE STOCKAGE up to 85 °C

1. White cotton
2. Colour cotton
3. Easy care
4. Delicate
5. Express
6. Handwash
7. Wool, Silk
8. Rinse & Spin
9. Intensive Spin
10. Gentle spin
11. Drain

POINTS DE CONTROLES

Aquastop (activated) AQ2.2 - (Vcc)		24 V
Pump (on)	DP2.1 - DP2.2	230 V
doorlock (on)	DL3.1 - DL3.3	230 V
Heating (on)	HE2.1 - HE2.2	230 V
Motor distributor(on) DI6.1- DI6.3		230 V
pressostat	PR6.4 - (Vcc)	24 V
- empty	PR6.6 - (Vcc)	24 V
- full(N1)	PR6.5 - (Vcc)	24 V
valve(on)	V2.1 - V2.2	>170 V

ELECTROVANNE D' ENTREE

TEMPERATURE DE L'EAU	60 °C
DEBIT	> 1 bar 8 l/min
PRESSION SUPPORTEE	0.5 bar - 10 bar
TENSION NOMINALE	220 / 240 V
FREQUENCE	50 Hz
COMMENCER LA TENSION	< 6 bar 160 V 6-10 bar 170 V
INTENSITE NOM.	35 mA
PUISSANCE DE RACCORDEMENT	6 VA Nominal resistor(20 °C) 3,4 - 4,5 k

ACTUATEUR DE DISTRIBUTION DÉAU

MOTEUR	
TENSION NOMINALE	230 + 10%, -15% V
INTENSITE NOM.	13 mA
RESISTANCE	± 10% k Ω

(20 °C) 6.5

CONTACT	
INTENSITE NOM.	1 mA
TENSION NOMINALE	24 V

POMPE DE VIDANGE*(synchronous)*

TENSION NOMINALE	220/ 240 V
INTENSITE NOM.	0.3 A
PUISSANCE DE RACCORDEMENT	34 W
FREQUENCE	50 Hz
RESISTANCE DU ENROULEMENT	155 ± 7% Ω
PROTECTION MOTEUR	yes (170°C)
CAPACITE	15 l/min

*(1.25m height)***PLATINE D’AFFICHAGE**

TYPE	DM 3D BK
NO DE FABRICATION	4619 710 70181
PROGRAMMES	11

MOTEUR

TYPE	MCA 52/64 - 148 t.f./ BkD0 i = 1 : 13,1
ENROULEMENTS (CONNECTEUR MOTEUR) ...	1 - 2 68.7 ± 7% Ω Collector directly 1.90 ± 7% Ω 5 - 6 1.60 ± 7% Ω 5 - 7 0.69 ± 7% Ω

FILTRE ANTIPARASITES

TENSION NOMINALE	230 V
CONDENSATEUR	680nFX1+2 x 22nF Y
INDUCTANCE	2 x 1 mH
RESISTANCE	470 k Ω

FILTRE ANTIPARASITES

TENSION NOMINALE	230 V
CONDENSATEUR	1 μ FX1+2x 0,22nFY
INDUCTANCE	2 x 1 mH
RESISTANCE	470 k Ω

AFFICHAGE

INDICATEUR DE TEMPS	
COMMUTEZ LE DEBUT	SST
COMMUTEZ PRE LE LAVAGE	SPW
TD SWITCH TEMP CHOOSE	+/
COMMUTEZ LE RINCAGE INTENSIF	SRI
COMMUTEZ LA PRISE DE RINCAGE	SRS
ESSORAGE VARIABLE	SSR

VUE ECLATEE

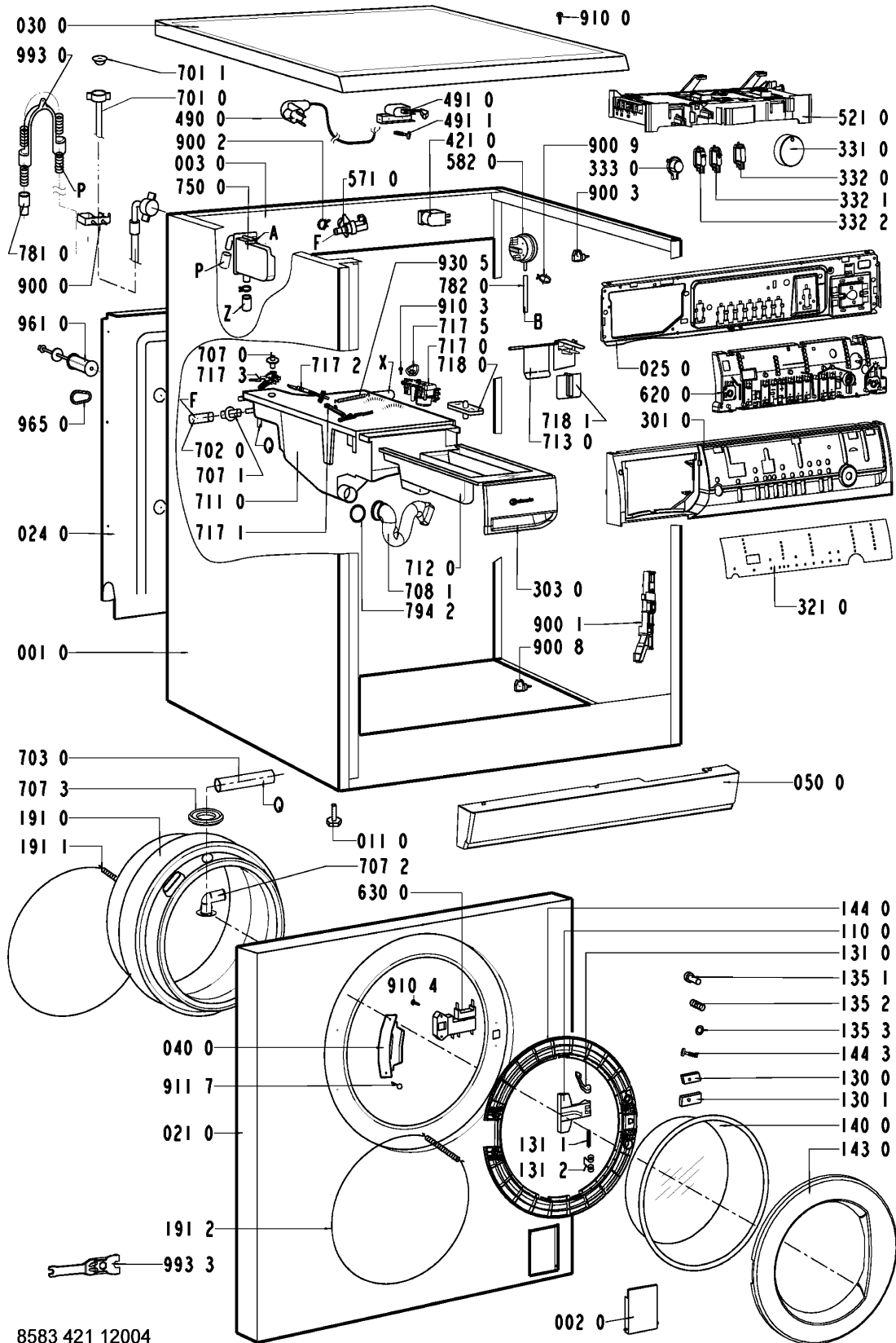

8583 421 12004

VUE ECLATEE

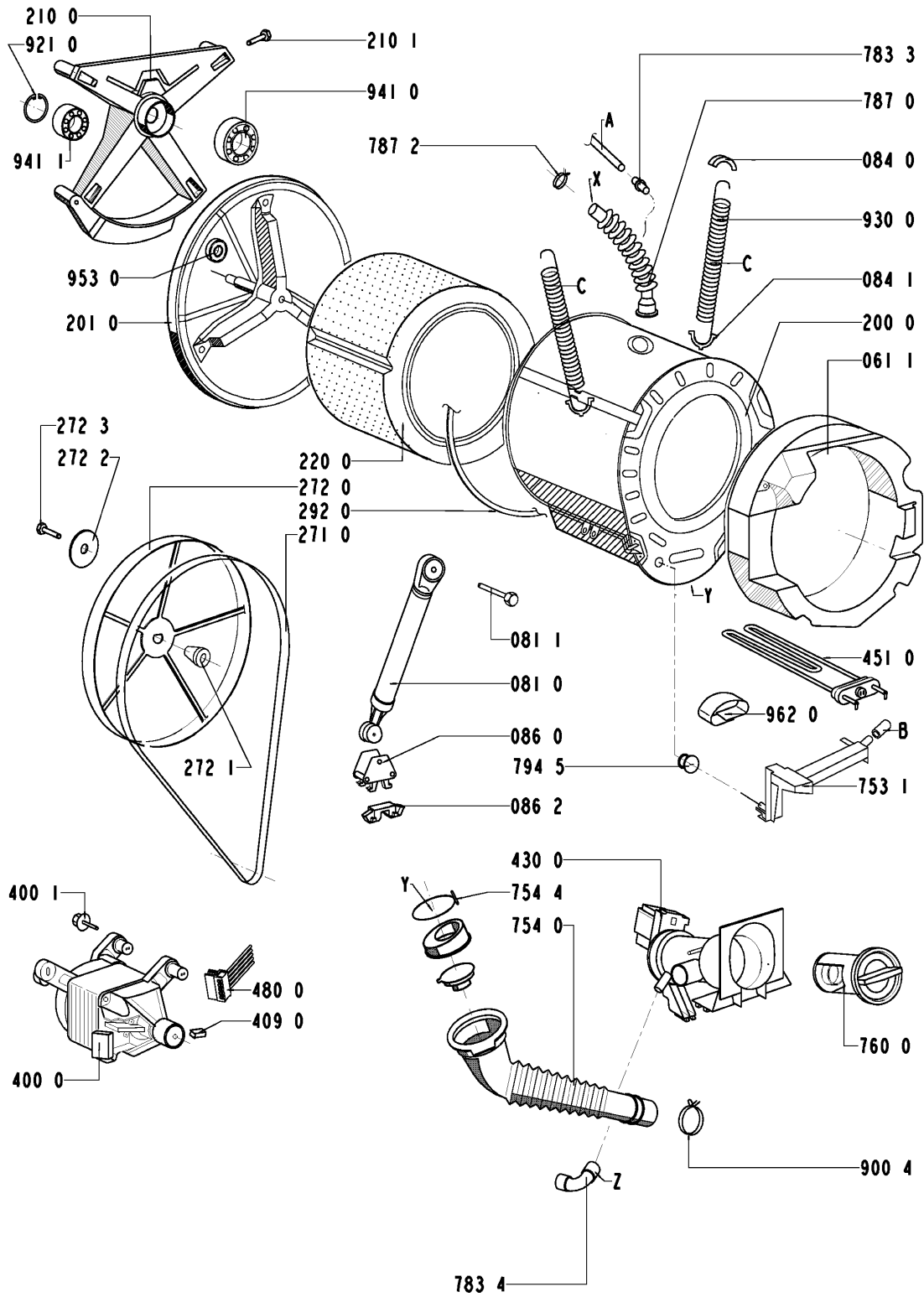

8583 421 12004

SCHEMA DE CABLAGE

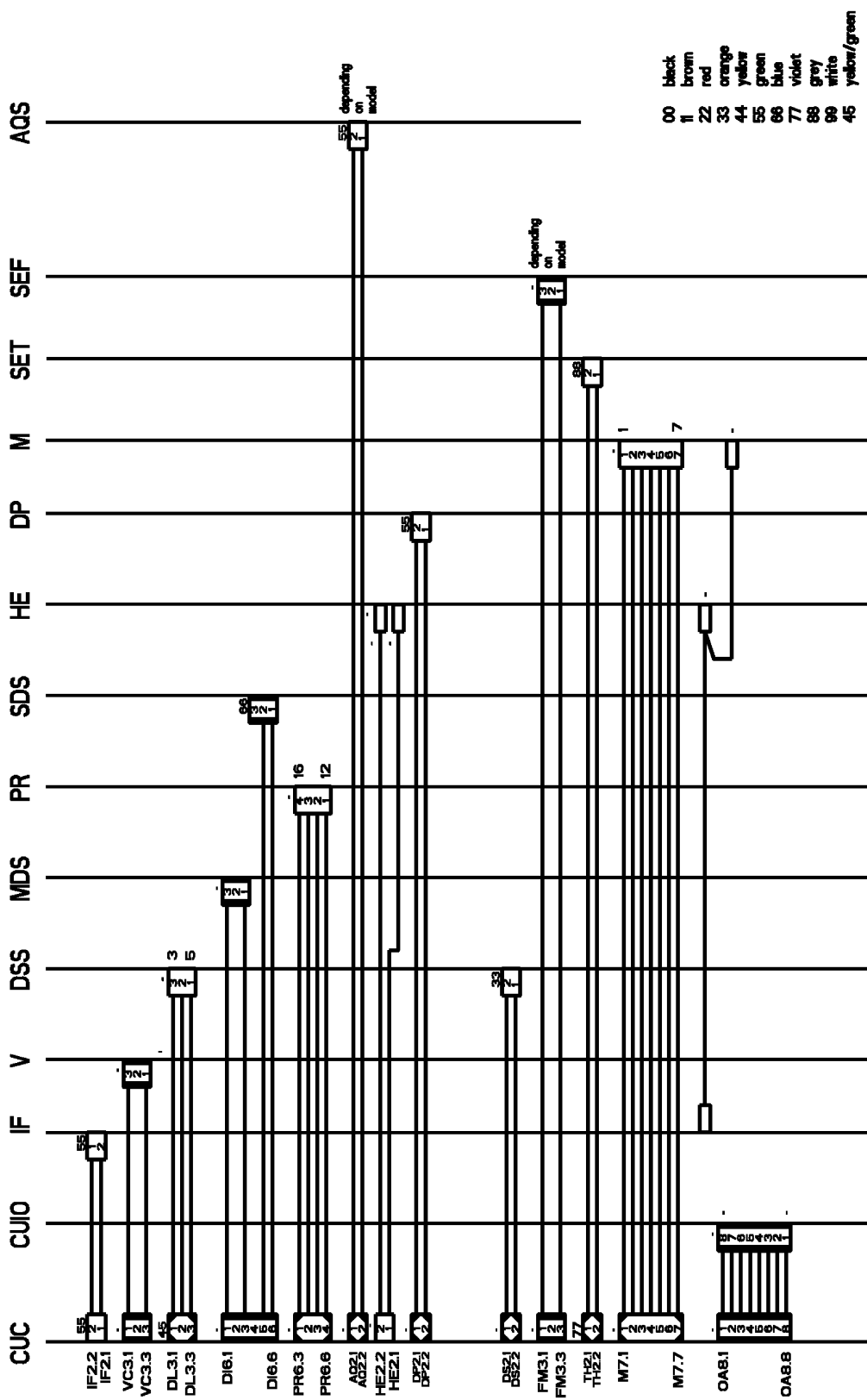

4619 712 57951

SCHEMA DE CIRCUITS

1 2 3 4 5 6 7 8 9 10 11 12 13 14 15 16 17 18 19 20 21 22 23 24 25 26 27 28 29 30 31 32 33 34 35 36 37 38

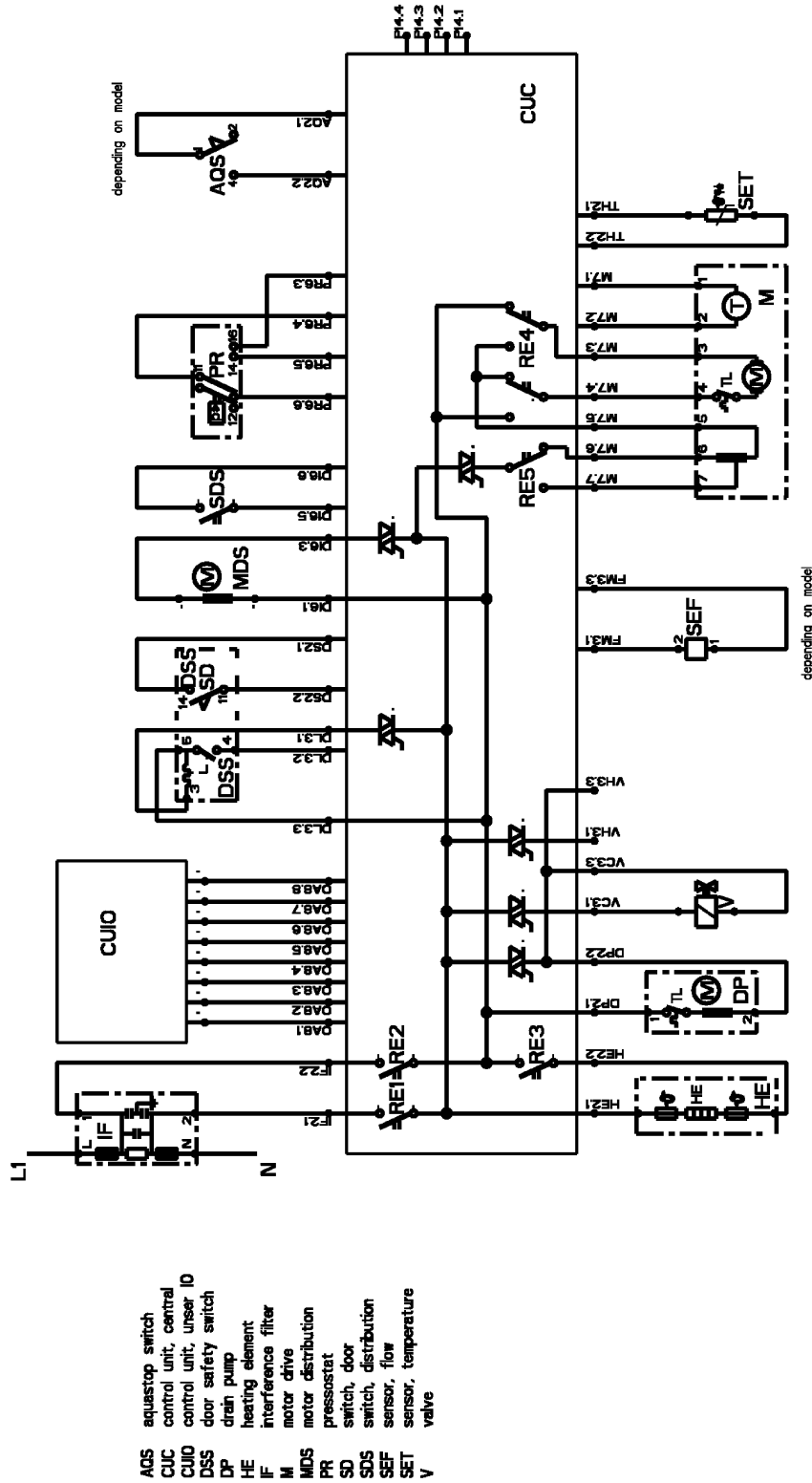

- ADS aquastop switch
- CUC control unit, central
- CUJO control unit, user ID
- DSS door safety switch
- DP drain pump
- HE heating element
- IF interference filter
- M motor drive
- MDS motor distribution
- PR pressostat
- SD switch, door
- SDS switch, distribution
- SEF sensor, flow
- SET sensor, temperature
- V valve

4619 712 57951

CHARTE PROGRAMME

OMEGA DELTA		Wash Cycles / Spin Cycles					Soap dispenser: 3 chambers					4619 712 37701-04		
	Wash Phase	Prewash	Enzym Phase	Main Wash	Rinse1	Rinse2	Rinse+	Rinse Soft	Extract					
Speed	max 960 54 40			Reversing period = 16 s ON = 10 .. 12 s / OFF = 6 .. 4 s Cool Down (60°, max 4 l)	LS1 230.. 240"	LS1 230.. 240"	LS1 230.. 240"	LS1 230.. 240"	LS1 230.. 240"	LS2 230.. 300"	ES 350.. 380"			
Level	L1													
Temperature	Dispenser Box Tsel 40 30	PW cold	MW cold (+ hot if avail.)	MW	MW	MW	MW	MW	MW					
Door	Door													
Load Influence	Pump (L1 + 30°)													
	load = 5kg no options	14 min		50 .. 70 min	11 min	11 min	11 min	11 min	11 min	15 .. 18 min	15 .. 18 min	7 min	7 min	7 min
	load < 3kg no options	14 min		40 .. 60 min	11 min	11 min	11 min	11 min	11 min	15 .. 18 min	15 .. 18 min	7 min	7 min	7 min
	load < 1 kg no options	14 min		25 .. 50 min 30 .. 40 min T max 60°	7 min	7 min	7 min	7 min	7 min	7 min	7 min	9 min	9 min	9 min
Options	RAPID selected													
	PREWASH selected	17 min												
	FLOW RINSE selected													
	ECO selected													
	EASY IRONING selected													
				Intermediate spinning 210° / max 650 rpm + 10 min / -10 K	more water max speed 650	more water max speed 650	more water max speed 650	more water max speed 650	more water max speed 650	more water max speed 650	more water max speed 650	more water max speed 650	more water max speed 650	more water max speed 650

CHARTE PROGRAMME

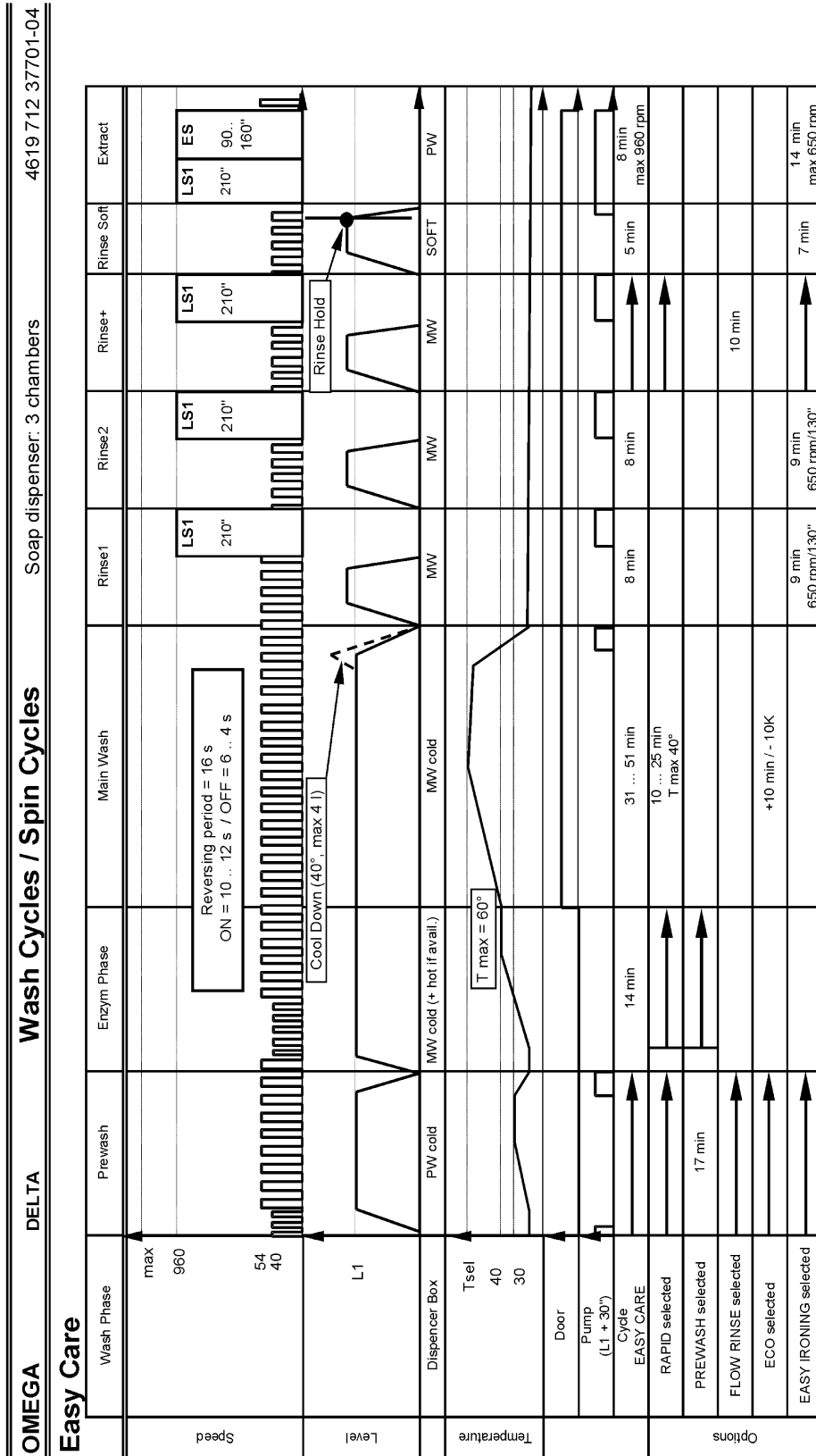

CHARTE PROGRAMME

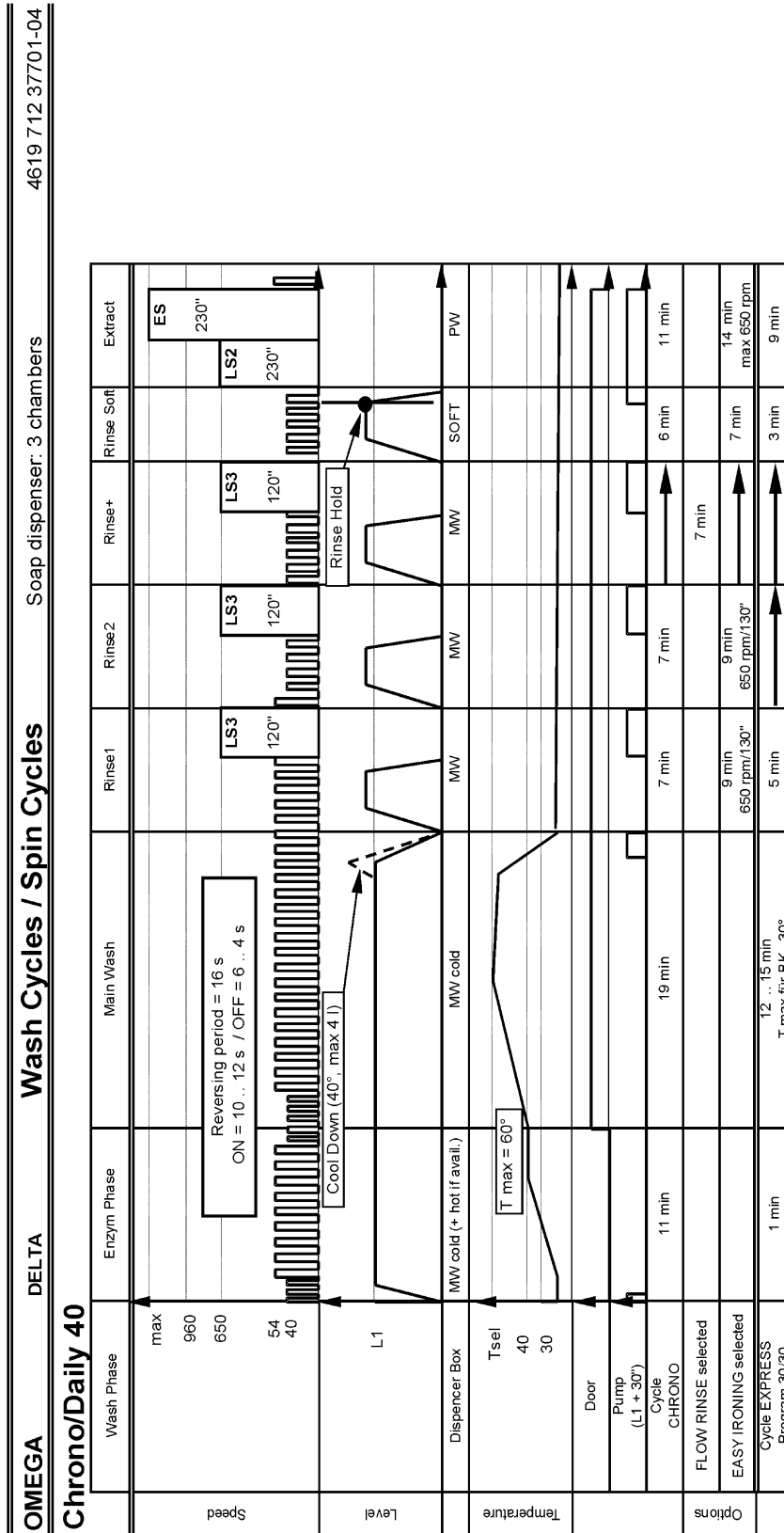

CHARTE PROGRAMME

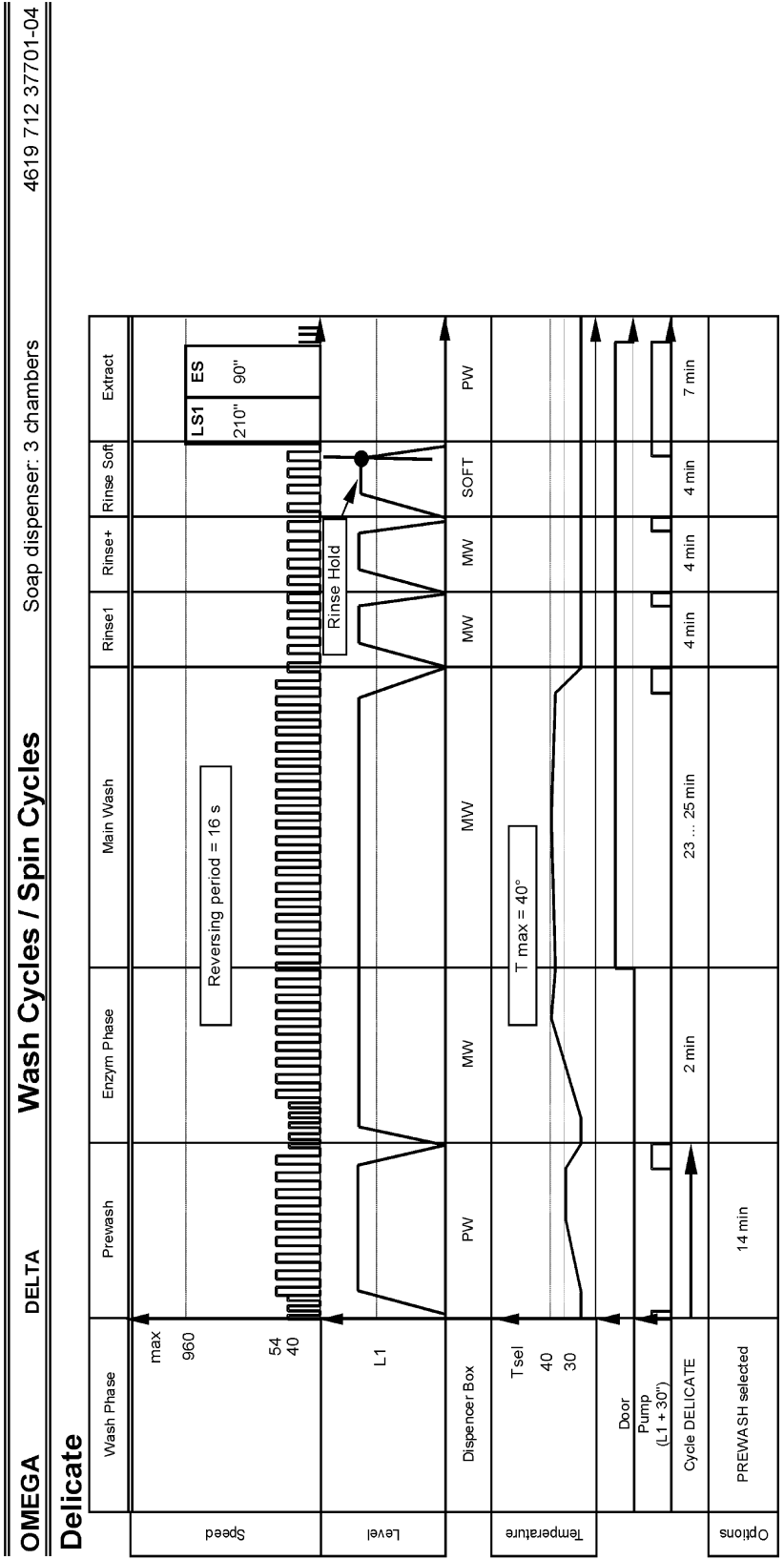

Reversing period: Normal Rhythm: ON = 4 s / OFF = 12 s
Gentle Rhythm: ON = 2.5 s / OFF = 13.5 s

CHARTE PROGRAMME

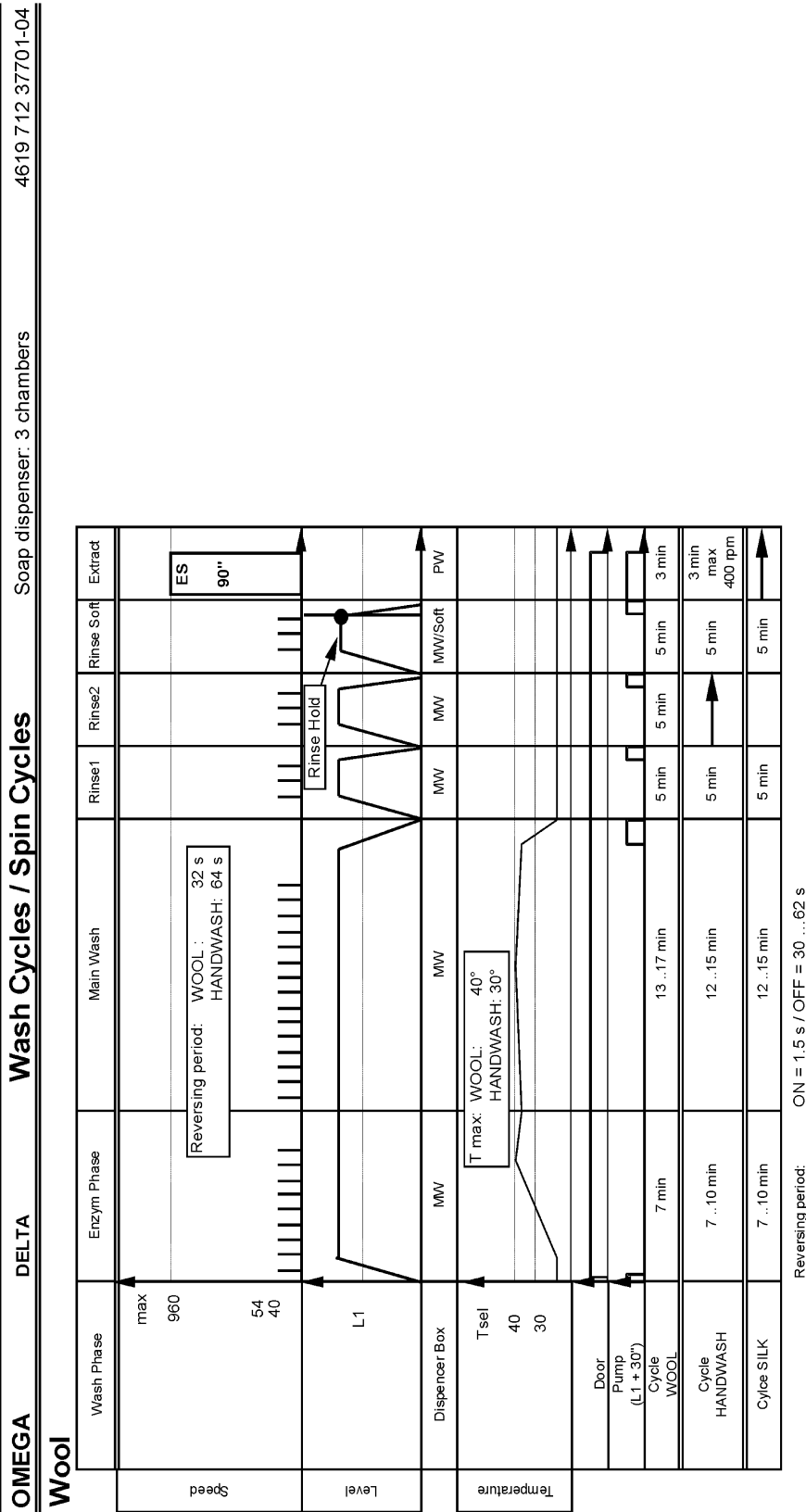

CHARTE PROGRAMME

OMEGA DELTA Wash Cycles / Spin Cycles Soap dispenser: 3 chambers 4619 712 37701-04

Spin Cycle : LS1

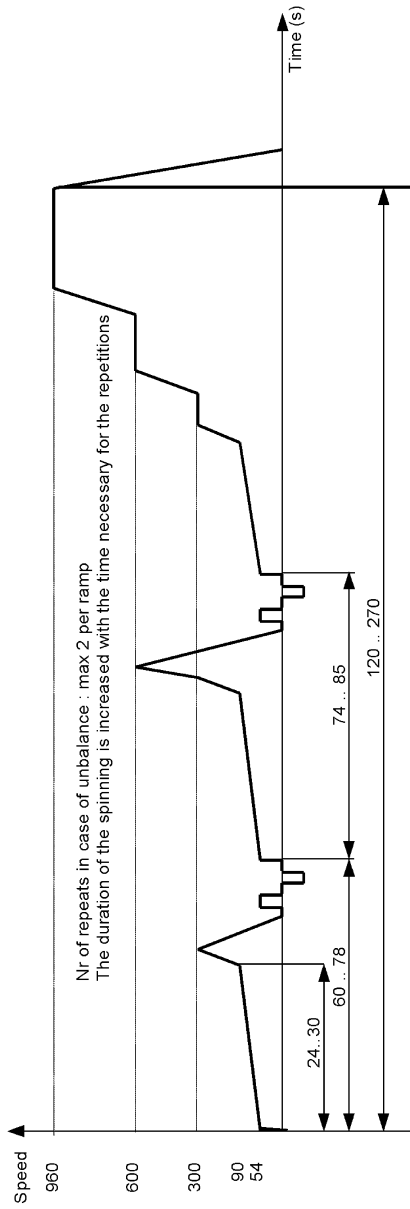

Spin Cycle : LS2

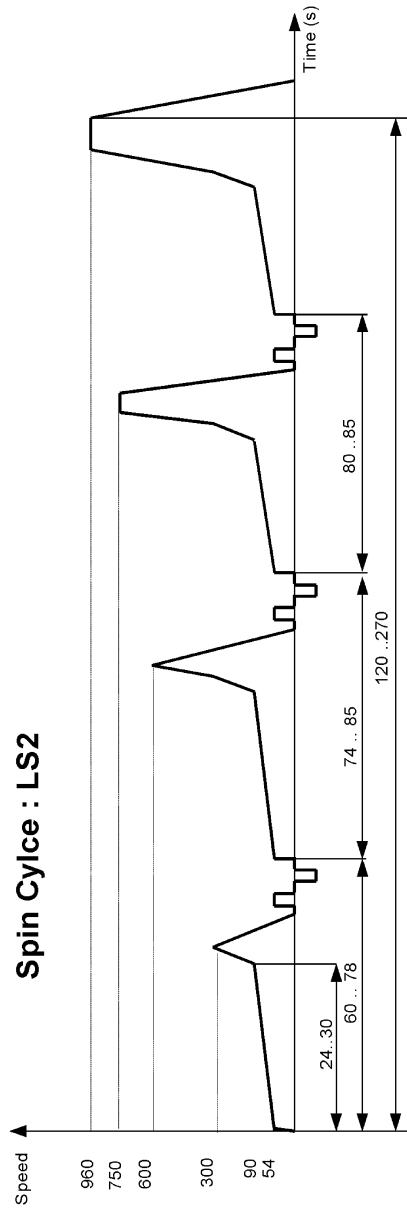

CHARTE PROGRAMME

OMEGA DELTA Wash Cycles / Spin Cycles Soap dispenser: 3 chambers 4619 712 37701-04

Spin Cycle : ES

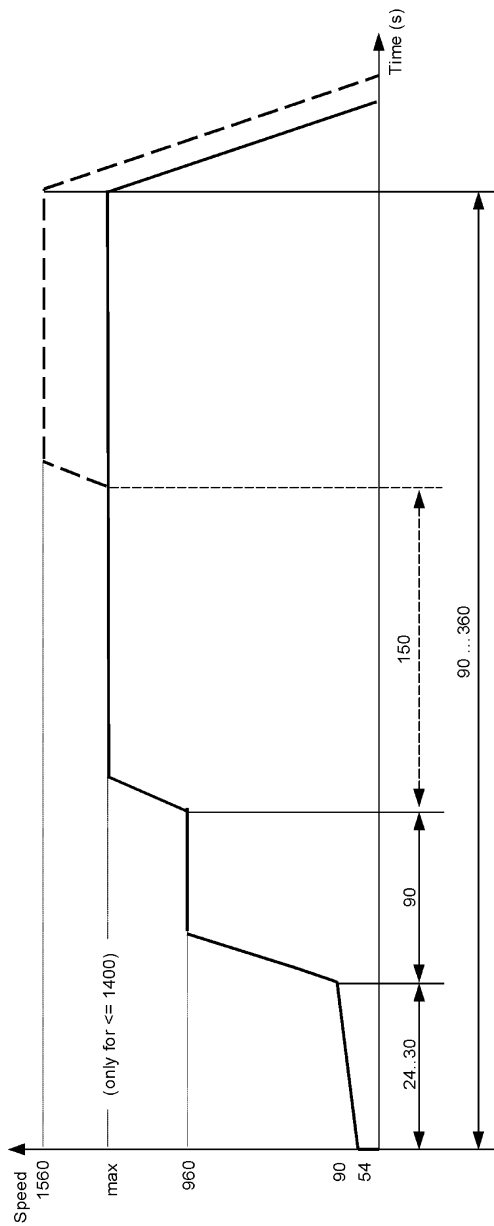

Nr of repeats in case of unbalance: max 11
 Nr of repeats in case of foam: max 3
 In the cycles WOOL and HANDWASH we don't have repeats
 The duration of the spinning is increased with the time necessary for the repetitions

LEGENDE DES TEXTES

OMEGA	DELTA	Test Program	4619 712 37701-04
1 →	Select program	Drain	
2 →	Start test program	Push prewash option 4 times within 5 seconds Indication Cx	
3 →	Indication elements	DIGITS rest time DIGITS temperature LED water tap LED start LED program flow	Indicate current program step Indicate current program step FLASHING ON FLASHING
4 →	Go to next step	Push prewash option twice	
5 →	Finish test program	Move the program selector from the DRAIN position	

Attention: Use the test program only without laundry!

Temperature Indication	Rest Time Indication	Function	Duration	Checked	Drum rhythm
C0	C0	Lock the door	Until the door is locked	Door Lock Function, Drum Up Switch	
C1	C1	Fill, current dispenser position	Until L1 is reached	Flowmeter	
C2	C2	Move dispenser motor to prewash		Dispenser	
C3	C3	Fill (cold + hot)	L1 + 30"		
C4	C4	Movement	10 ..15"	Motor	Drum CW 54 rpm
C5	C5	Wash + Heat	max 90° (50°) + 1 min	Heater	Drum CW 54 rpm
C6	C6	Drain	L1		Drum CW 54 rpm
C7	C7	Ramp	15"	Motor	Drum CCW Ramp 54 - 90 rpm
C8	C8	Spin (max speed)	240"	Motor	Drum CCW max speed

If failure occurs The test program is stopped
 Buzzer will beep 30 "
 Speed LEDs are flashing
 Failure indication on rest time digits and/or temperature digits see next page

LEGENDE DES TEXTES

OMEGA		DELTA	Test Program	4619 712 37701-04
DIGITS Temperature	DIGITS Rest Time	Detected failure		To be checked
F H	FH	No water inlet		Water Tap / Valve / Flowmeter / Pressostat
F A	FA	Aquastop failure		Aquastop Switch / Overflow contact Pressostat
F P	FP	Drain failure		Drain Pump / Pressostat
F 5	F5	NTC failure (SC / OC)		NTC
F 6	F6	Tachometer failure (no motor movement detected)		Motor, Tachometer
F 7	F7	Triac short circuit detection		Control Board, Motor
F 8	F8	Heater failure (no feedback on Heater safety)		Heater, Control Board
F 10	F10	Temperature sensor defect		Motor Control Unit, Motor
F 11	F11	Communication failure control board- motor control unit, only for chopper appliances		Control Board, Motor Control Unit
F 12	F12	Heater safety failure		Heater, Control Board
F 13	F13	Dispenser circuit failure		Dispenser actuator
F 14	F14	EEPROM failure		Control Board
F21	F21	Communication failure control board- user board, only for BK-VBL, LCD appliances		Control Board, User Board

In the failure state all actuators are switched OFF. The mains relays are opened.
Exception: During aquastop/overflow failure the drain pump is switched ON.

The ERROR state is canceled if the program selector is set to OFF position.

LEGENDE DES TEXTES

OMEGA	DELTA	Test Program	4619 712 37701-04
-------	-------	---------------------	-------------------

Failure detection:

Detected in step	Description	Detection time	Indication
FILLING	No flowmeter pulses detected at the beginning of the step.	60"	FH
FILLING	If the level 1 is not switched ON after a certain time.	8 min	FH
ALL	If the aquastop switch = ON: (drain pump = ON; wait 60") If aquastop switch = ON (drain pump = ON; failure mode)	60"	FA
ALL	If the overflow contact = ON: (drain pump = ON; wait 60") If the overflow contact = ON (drain pump = ON; failure mode)	60"	FA
DRAINING	If the level 1 is not switched OFF after 4 min of draining.	4 min	FP
HEATING	NTC value = 0 // NTC values > 36 kOhm	10"	F5
HEATING	Heating element interrupted (not connected)	10"	F8
ALL (except HEATING)	Heating relay stuck closed. Heater sc to ground.	10"	F12
ALL	No tacho signal. Failure is declared after 10 trials.	10 min	F6
ALL	Triac short circuit detected. Failure is declared after 10 trials.	10 min	F7
FILLING	No (wrong) feedback from the dispenser contact during movement of the dispenser.	5min	F13
ALL	Wrong data read from internal EEPROM.	30"	F14
ALL	No communication control board and user board (on smart = BK VBL, LCD appliances)	2 min	F21
ALL	No communication control board and motor control unit (on chopper appliances)	2 min	F11
SPINNING	Overdosage detection If the contact pressostat overdosage contact = ON then stop spinning. Drain until the level foam contact = OFF. Reset timing. Restart current peak. Max 3 repeats		
SPINNING	If the contact door lock = OFF (door not locked) then no spinning performed		
HEATING	If the contact door lock = OFF (door not locked) then max temperature = 40°		
ALL	Temperature sensor defect on motor control unit (only chopper)	2"	F10

LEGENDE DES TEXTES

Timer OMEGA Delta (fully electronic) 230V, 50Hz

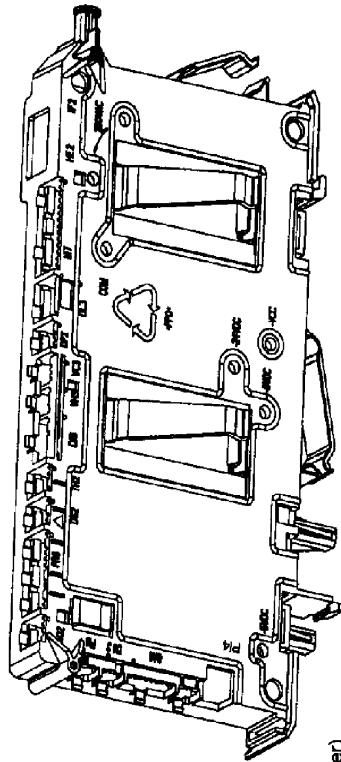

- | | |
|-----|--|
| AQ2 | aquastop switch |
| OA8 | control unit, user IO |
| DS2 | door switch (safety) |
| DP2 | drain pump |
| DU3 | drum up |
| HE2 | heating element |
| IF2 | interference filter |
| M7 | 7 pol. motor |
| DI6 | 6 pol. control unit motor (only chopper) |
| PR6 | switch / motor distribution |
| DL3 | pressostat |
| FM3 | door switch (lock) |
| TH2 | sensor, flow |
| VC3 | sensor, temperature |
| VH3 | valve, cold fill |
| PI4 | valve, hot fill |
| | program. input |

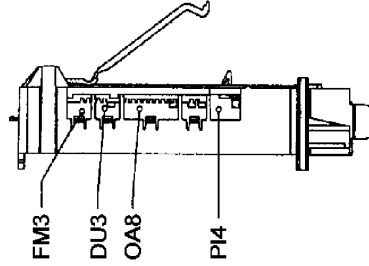

Test points for Omega 2
no longer available!

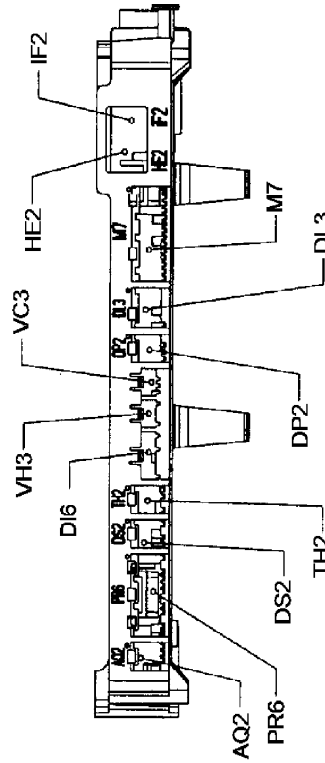

4619 712 37701-04